

elan 410

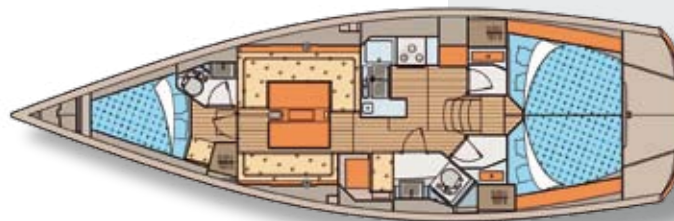
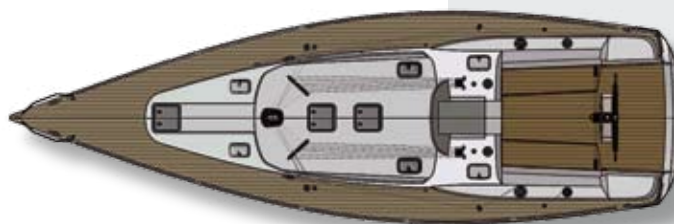
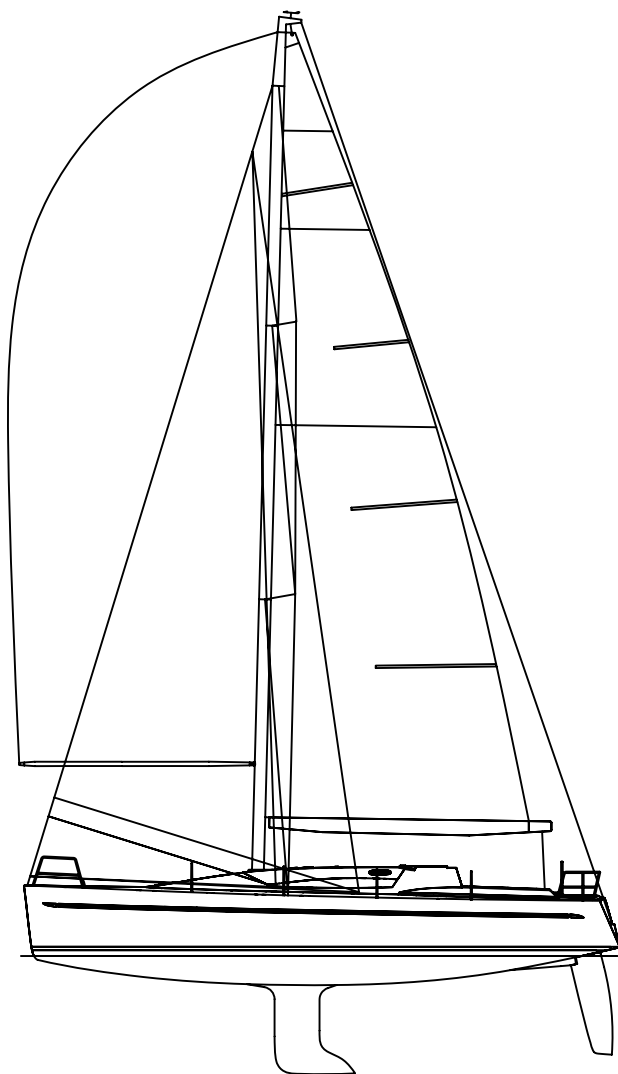

Technical specifications

Length overall	12,27 m
Hull length	12,27 m
Length at waterline	11,28 m
Beam	3,91 m
Draft	2,10 / 2,45 m
Displacement	approx. 8300 kg
Ballast	2500 kg
Water capacity	355 l
Fuel capacity	145 l
Engine	40 HP
Mainsail	50,7 m²
Genoa	55,2 m²
Spinnaker	138,89 m²
I	16,66 m
J	4,63 m
P	16,16 m
E	5,43 m
Boat design category	CE A
Interior design	Boris Lubej
Design	Rob Humphreys

January 2007

All measurements, images and illustrations are approximate and provided for information only. Elan Marine reserves the right to modify or improve specifications without prior notice.

elan 410

CERTIFICATION

ELAN 410 is delivered with a CE certificate and meets the requirements of European directive 94/25/CE for recreational crafts. The CE class A category certificate (unlimited Ocean voyages) is issued by Germanischer Lloyd.

CONSTRUCTION

The hull is laminated with high quality materials: Sandwich construction using multi-directional fibreglass, low density closed cells fume core on hull sides and single skin on loaded areas, vinylester skin cote and isoftalic polyester resin // 3D VAIL advanced resin infusion technology to considerably improve strength, mechanical and chemical properties of the hull // Powerful inner structure distribute all loads from the keel and rig effectively with a minimum flexing of the hull // The deck is laminated in classic hand lamination technology with low density balsa core to assure thermal and sound isolation. Moulded anti slip surface on deck and coachroof // 2,10m draft performance lead keel // Teak toe rail

DECK EQUIPMENT

transom helmsman seat / gangway // Harken deck equipment // 2 x Harken B44.2 STA halyard winch // 2 x Harken B48.2 STA genoa winch // 2 x Harken B44.2 STA main sail winch // 2 x winch handles with holder // German sheeting system for mainsail with sheets leads below deck level // Harken mainsail track with mainsheet traveler and lines // Harken genoa tracks with travelers and lines // S/S tip caps chainplates for shrouds // S/S chain plates for fore- and back- stay // 1 x foredeck opening hatch on deck above berth in forward cabin // 2 x foredeck opening hatches in forward cabin // 2 x flush opening hatches on coachroof with gas opening shocks above saloon // 1 x opening hatch on deck above galley // 1 x opening hatch on deck in head compartment // 1 x opening hatch on deck in port aft cabin // 1 x opening portlight in cockpit to port aft cabin // 1 x opening hatch on deck in starboard aft cabin // 1 x opening portlight in cockpit to starboard aft cabin // 2 x side cockpit lockers // 2 x side lockers in transom with gas lifting shocks // 3 x lockers in cockpit floors with gas lifting shocks (center one suitable for liferaf) // 1 x gas bottle locker draining outboard // S/S bathing ladder // S/S grab rails on coachroof // Steering wheel Jefa 1600mm with leather cover // Wash boards with

possibility of closing independed of sliding hatch // Jackstays attachments on deck (5pcs) // S/S pulpits, pushpits and stanchions with lifelines // Compass on steering pedestal // S/S removable steamhead // Teak on cockpit seats (vacum assisted) // Teak on cockpit floor (vacum assisted) // 4 mooring cleats (2 aft, 2 foredeck)

MAST AND RIG

Selden keel stepped aluminium anodised mast fractional // Two swept back spreaders in aluminium // Standard running rigging includes: 1 x main halyard, 1 x genoa1 halyard, 1 x spinnaker1 halyard, 1 x spinnaker pole lift // Selden aluminium anodised SLR boom: 1 x outhaul, 1 x reef1, 1 x reef2 // Standing rig: conventional // Rod kicker with gas spring // Furler for head sail // Hasselfors mechanical tensioner for backstay // Windex // Mast flood and Steaming light

INSTALLATIONS

FRESH WATER SYSTEM

Fresh water tanks 355l // 12V fresh water pump // central electric bilge pump with automatic switch // hand bilge pump in cockpit

HOT WATER SYSTEM

hot water tank (boiler) heated by engine cooling water // or by integrated heater run with 230V shore power

ENGINE EQUIPMENT

D2-40 Volvo Penta // Sail Drive // Engine control lever in cockpit // Engine control panel with engine hour counter // Fuel tank (145l) with fuel filter and water separator // 2 blade fixed Volvo Penta propeller

ELECTRICAL SYSTEM

12V circuit // control panel with voltmeter for batteries, fresh water and fuel level indicator // 2 x batteries 90Ah // engine alternator 115Ah // navigation lights according to ColReg // 230V electricity, 230V socket in navigation corner // battery charger 12V/20Amp

GAS SYSTEM

3kg butane-propane gas bottle // 30mbar pressure - relief valve with a shut-off valve

INTERIOR

Standard layout: 3 cabins (2 aft, 1 in front) and 1 toilette in aft // Wetlocker 370l with drainage

SALOON

folding saloon table // lockers and shelves above bachests along the hull on both sides // overhead lights // blue Elan upholstery

GALLEY

L - shaped galley // Cooling box 100l - top opening // S/S 3 flame cooker with oven // double sink // tap with pressurized water system // lockers, cupboards and drawers above and under the worktop // place for detergents // bottle drawer // overhead lights // light over the worktop

NAVIGATION STATION

chart table // reading LED spotlight // 12V socket in navigation corner // book shelves, lockers and drawers // control panel

HEAD / SHOWER COMPARTMENT

marine toilette // washbasin with pressurized tap // storage locker under the sink and behind the toilette // locker with mirror // 1 electric bilge // pump // overhead light // Teak trim floors in shower compartment

FORWARD CABIN

1 double berth with dimensions 210 x 185cm // 2 lateral stowage shelves // 2 lockers to port and starboard // 2 drawers under berth // stowage under berth // 2 seats beside berth // 1 reading light // overhead lights

AFT CABINS

1 double berth with dimensions 210 x 150cm // storage under the berth // 1 double locker (hanging and shelves) // 1 lateral storage shelf // 1 reading light // overhead light

MISCELLANEOUS

owner's manual // 2 fire extinguishers // flag pole

Elan Marine d.o.o.

Begunje 1, SI-4275, Begunje na Gorenjskem, Slovenia

Phone: +386 4 535 13 70, Fax: +386 4 535 13 60

E-mail: elan.marine@elan.si

www.elan-yachts.com

